

DYNAMIC MICROPHONE

MODEL TMN6054A

electrical parts list

important
Use *only* the following Motorola part numbers when ordering replacement parts.

REFERENCE SYMBOL	MOTOROLA PART NO.	DESCRIPTION
DP1	59-83272G01 or 59-84013A01 or 59-82933C02	cartridge, microphone: dynamic; includes transistor preamplifier
P1103	—	connector, plug: part of W1
W1	30-83731M01	cord, microphone, coiled: 4-conductor; includes ref. part P1, CLAMP, cable "S" hook (ref. part 13), SPRING, strain relief (ref. part 12), and non-ref. LUG (4 req'd.) 29-83277G02
S1	40-82263G02	switch, push: dpst
non-referenced items		
	29-83277G02	LUG, insulation piercing: 4 req'd. (p/o W1)
	33-82599D01	NAMEPLATE
	13-84599B01	EMBLEM

mechanical parts list

CODE	MOTOROLA PART NO.	DESCRIPTION
1	38-84559B01	PUSHBUTTON
2	3-140000	SCREW, tapping: no. 6-19 x 3/8"; 3 req'd.
5	3-122830	SCREW, tapping: no. 8 x 1/2"; 2 req'd.
6	1-80707T05	BRACKET & SPRING ASSY. (eyeletted)
7	1-80709B93	HOUSING, microphone (front and rear)
8	3-129498	SCREW, lock: no. 6-32 x 5/16"; "Phillips" round head
9	4-7666	LOCKWASHER: no. 6 external
10	42-852710	STRAP, strain relief
11	3-139999	SCREW, tapping: no. 6-19 x 3/4"; "Phillips" round head; 2 req'd.
12	41-852707	SPRING, strain relief (p/o W1)
13	42-893647	CLAMP, cable "S" hook (p/o W1)
15	42-82702B02	RETAINER, cartridge
16	32-82703B01	GASKET, neoprene
17	11-2506	TUBING, no. 9 black; 5" length req'd.

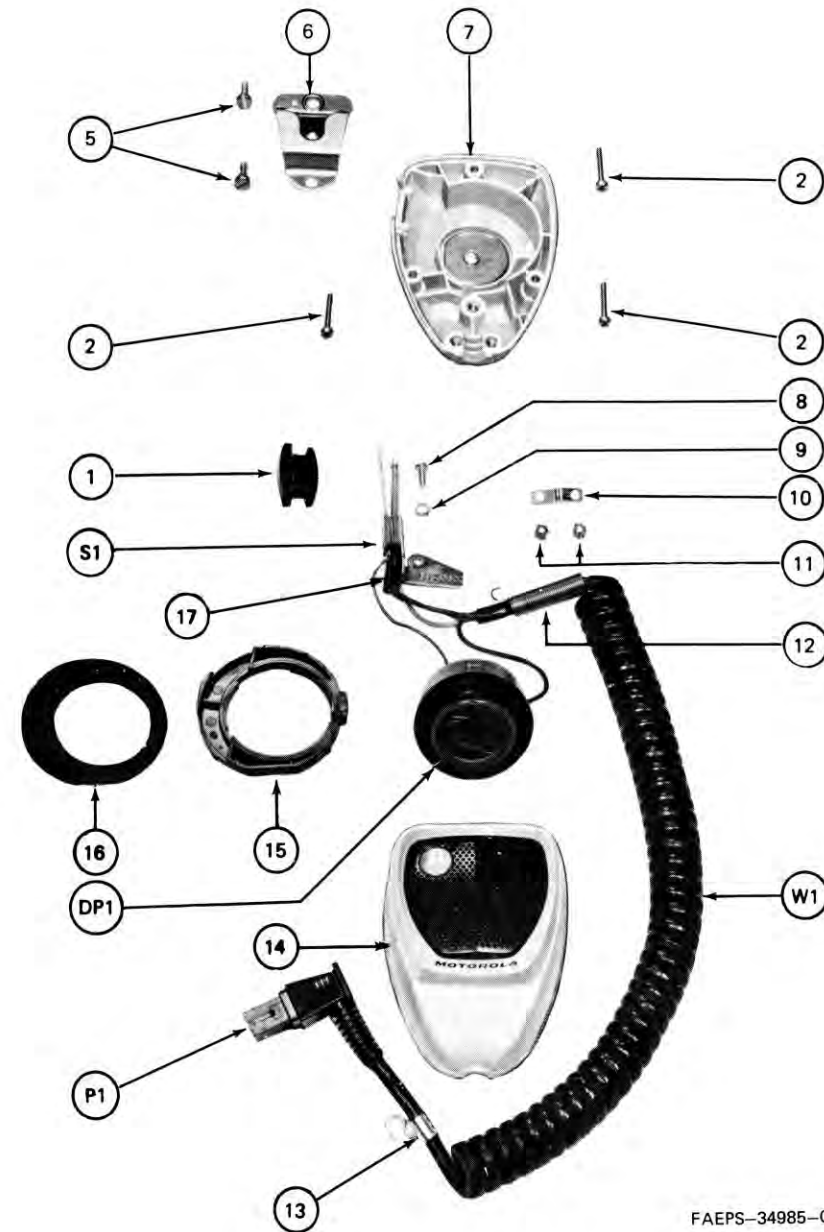

FAEPS-34985-0

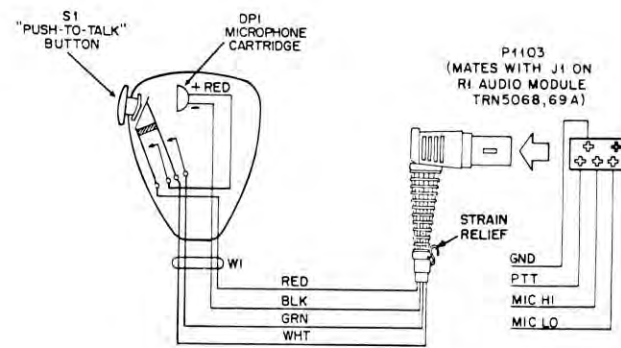

AEPS-34913-0

68P81062E39-0

7/12/82 - V & G