

INSTALLATION INSTRUCTIONS FOR HUMP MOUNT HARDWARE KIT 19A130890G1 AND CONTROL UNIT/SPEAKER KIT 19A130889G1 (OPTION 9079)

LB130732
(DF8414)

Hump mount Option 9079 provides the necessary parts to mount a MASTR® II or EXEC II mobile radio control unit and speaker to the hump in an automobile or other vehicle. The option includes a hump mount support and a control unit/speaker mounting assembly (refer to illustration and parts list).

In install a radio control unit and speaker using the hump mount option, complete the following steps:

1. Mount hump mount support 19B227124G1 to the vehicle using 10-16 x 5/8 screws. Use the longer 10-16 x 1-1/2 screws to reach through spacers, carpet, padding, etc. where required.
2. Attach control unit support 19B227120G1 to the hump mount support using 10-32 x 38 thread forming screws. The support may be rotated to a convenient angle, for the operator.
3. Install the MASTR II control unit into the control unit support using existing control unit screws. Install the EXEC II control unit into the control unit support using spacers 19A130867G1 and 10-32 x 1 machine screws.
4. Install speaker assembly into speaker support 19A130804G1 using existing speaker assembly screws.
5. Mount hookswitch on the side of the control unit support as desired, using 6-32 x 1/4 tap screws.
6. Install the speaker and speaker support into the control unit support using 10-32 x 3/8 machine screws. This completes installation of hump mount Option 9079. For cable connections to the control head and speaker, refer to the applicable system maintenance manual.

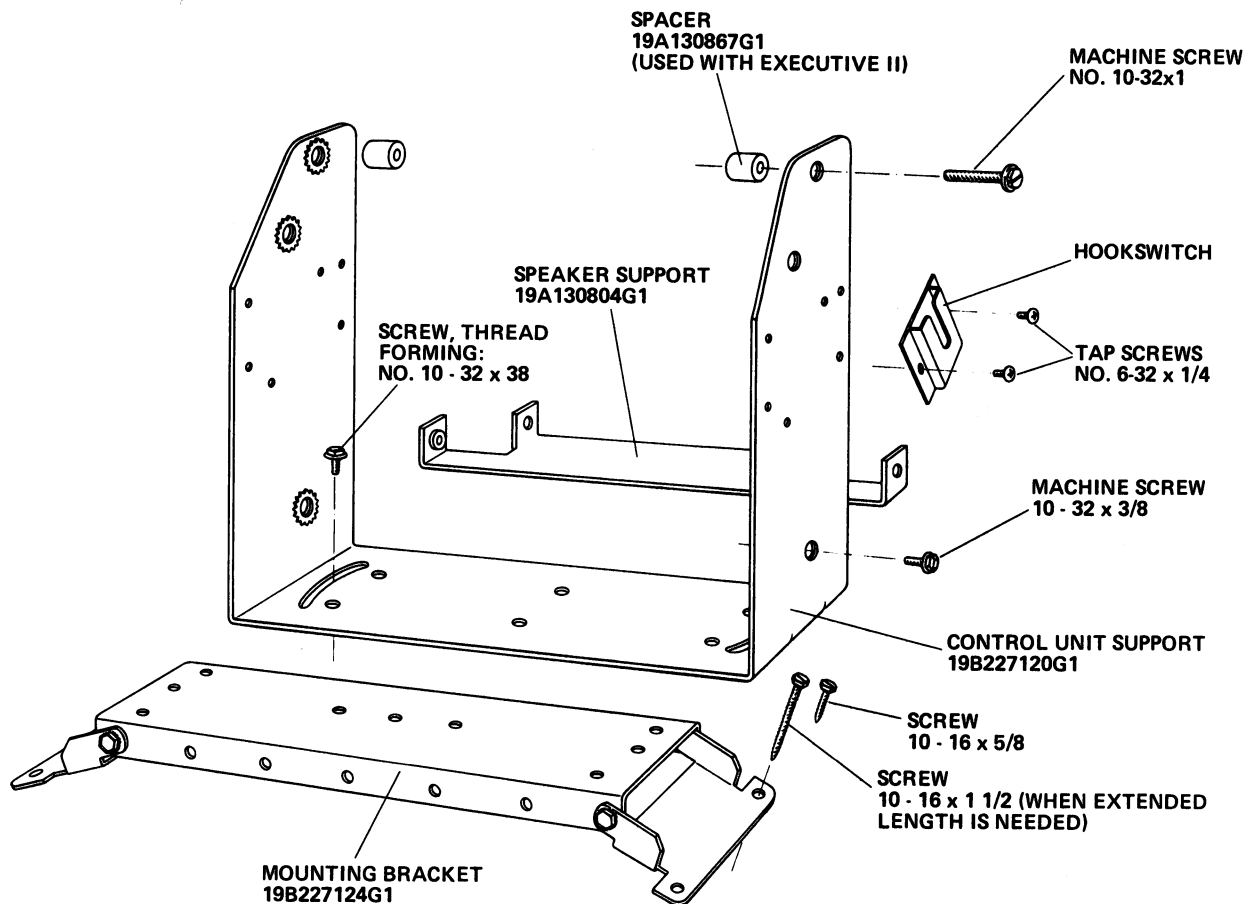

PARTS LIST**HUMP MOUNT HARDWARE KIT
19A130890G1**

SYMBOL	GE PART NO.	DESCRIPTION
	19B227124G1	Mounting bracket. (Mates with floor hump).
	N130P1610C6	Screw, thread forming: No. 10-16 x 5/8. (Secures mounting bracket to hump when extended length is not needed).
	N130P1624C6	Screw, thread forming: No. 10-16 x 1 1/2. (Secures mounting bracket to hump when extended length is needed).
	19B209103P906	Screw, thread forming: No. 10-32 x 3/8. (Secures mounting bracket 19C321086P2 to hump bracket).
	N403P19C6	Lockwasher, external tooth. No. 10. (Used with all No. 10 hardware).

PARTS LIST**CONTROL UNIT/SPEAKER KIT
19A130889G1**

SYMBOL	GE PART NO.	DESCRIPTION
	19B227120G1	Control unit support.
	19A130804G1	Speaker support.
	N187P16006P2	Machine screw, slotted, hex/washer head: No. 10-32 x 3/8. (Secures speaker assembly into control unit support).
	N187P21016P2	Machine screw, slotted, hex/washer head: No. 10-32 x 1. (Secures control unit to control unit support).
	19B201074P304	Tap screw, Phillips POZIDRIV®. No. 6-32 x 1/4. (Secures hookswitch to side of control unit support).
	19A130867G1	Spacer. (Located between control unit and control unit support).

MOBILE RADIO DEPARTMENT
GENERAL ELECTRIC COMPANY • LYNCHBURG, VIRGINIA 24502

GENERAL  **ELECTRIC**