

Installation Manual

VEHICLE HANDSFREE KIT
KRY 101 1613

NOTICE!

This manual covers Ericsson and General Electric products manufactured and sold by Ericsson Inc.

This manual is published by **Ericsson Inc.**, without any warranty. Improvements and changes to this manual necessitated by typographical errors, inaccuracies of current information, or improvements to programs and/or equipment, may be made by **Ericsson Inc.**, at any time and without notice. Such changes will be incorporated into new editions of this manual. No part of this manual may be reproduced or transmitted in any form or by any means, electronic or mechanical, including photocopying and recording, for any purpose, without the express written permission of **Ericsson Inc.**

Copyright © September 1995, Ericsson Inc.

TABLE OF CONTENTS

	Page
GENERAL	3
WIRING TO AN EXTERNAL ANTENNA.....	4
MOUNTING THE CRADLE.....	5
WIRING TO THE VEHICLE'S BATTERY.....	6
MOUNTING THE MICROPHONE..	7
INSERTING AND REMOVING THE RADIO.....	8
SPECIFICATIONS.....	9
TROUBLESHOOTING	10

GENERAL

The VEHICLE HANDSFREE KIT provides for the safe and easy use of the DPE-100 portable radio in a vehicle.

The VEHICLE HANDSFREE KIT powers the radio with the vehicle's battery and provides a microphone and speaker for handsfree use.

- The kit includes the following
- Handsfree cradle
- Mounting brackets
- Microphone and clip
- Antenna interface cable with TNC connector
- Cradle power cable
- Fuse kit

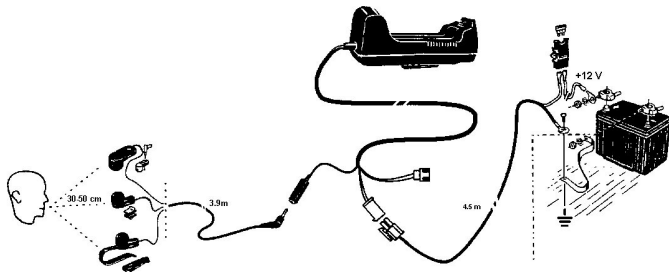

WIRING TO AN EXTERNAL ANTENNA

An external antenna (to be purchased separately) greatly improves performance.

NOTE

The package includes an external antenna cable, but do not install it unless the external antenna is installed. When the external antenna cable is connected, the radio's internal antenna is bypassed.

Take the following steps to install the antenna cable:

1. Remove the plastic insert from the antenna connection hole at the top back of the cradle.
2. Push the long connector on the antenna cable through the hole.
3. Press the connector into the hole until it snaps into place and close the opening of the back of the cradle with the grommet found on the antenna cable. Press the antenna cable into the retainer at the bottom of the cradle.

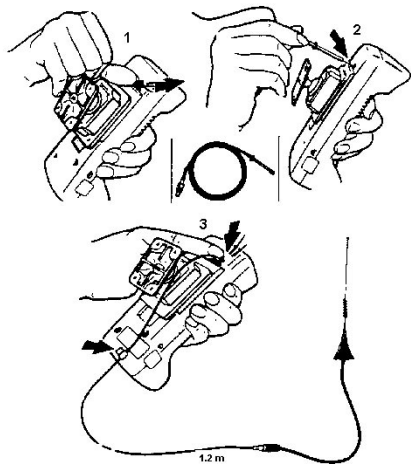

MOUNTING THE CRADLE

Follow the steps below to attach the cradle to the swivel mount. Locate the cradle within easy reach of the driver where it will not obstruct driving.

SWIVEL MOUNT

Place the swivel joint into desired position and mark the drilling area using the holes as a template. Be sure to check the drilling area for hidden obstacles before drilling. Drill the marked holes for unit placement.

1. Place the ball joint against the pocket mount. Insert the large screw through the center of the ball joint & pocket

mount and loosely attach with the nut and the back of the pocket mount.

2. Place the unit on the drilled holes and mount it with the screws provided.
3. Adjust the ball joint to desired position and tighten the center screw within the ball joint.
4. Slide the cradle over the angled guides and push down until the cradle is secure

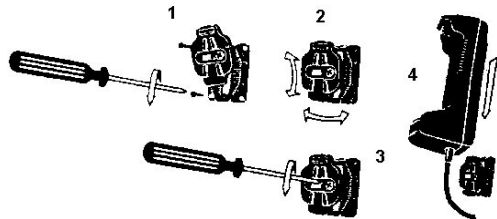

WIRING TO THE VEHICLE'S BATTERY

1. Cut a short 6 - 8 inch length of red wire from the power cable.
2. Use the short length of red wire to connect one terminal of the fuse holder to the positive battery terminal (12 V. battery with negative ground only).
3. Connect the power cable's red wire to the other terminal of the fuse holder.
4. Connect the power cable's black wire to ground and insert the 3 Amp fuse into its holder.
5. Route the cradle power cable and push it into the cradle's power jack.

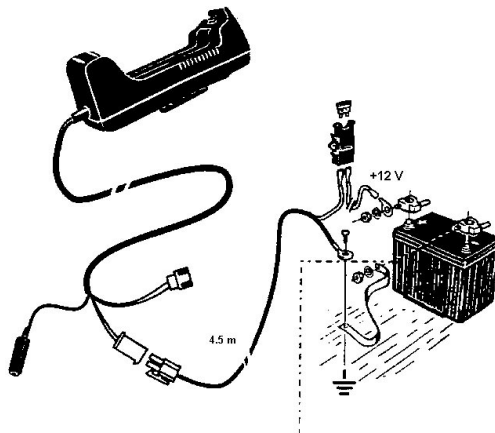

MOUNTING THE MICROPHONE

1. Locate the microphone out-of-the-way about 8-12 inches from the driver's face and away from windows or other sources of noise. Use the visor clip or adhesive strip to mount the microphone. **ALWAYS USE THE VISOR CLIP IF POSSIBLE.** The bulb on the microphone must be toward the driver and the mike wire must lead away from the driver. Route the mike wire away from vehicle parts that could damage insulation or cut the wire.
2. Plug the microphone into the black cylindrical jack at the end of the cradle cord.

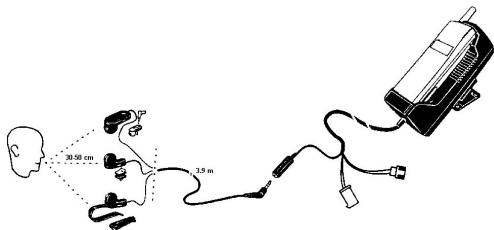

NOTE

Be especially careful not to pull the mike cable or poke it with installation tools.

INSERTING AND REMOVING THE RADIO

Before inserting the radio, check to see if the battery is medium, high, or extra high capacity.

If the battery is medium, fold out the support before inserting the radio.



MEDIUM



INSERTING THE RADIO

1. Find the small grooves on the sides of the radio at the bottom, and align them with the guides in the base of the cradle. Place the radio straight down into the cradle. The antenna should rest over the groove at the top left of the cradle.

2. With the base of the radio in place, gently push the top back into the cradle until you feel it snap in.

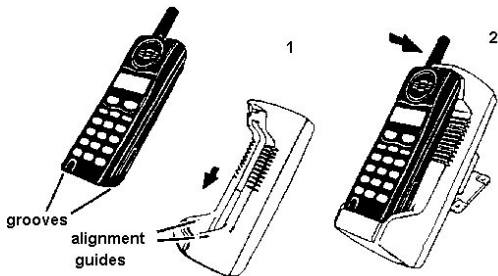

If the battery is high or extra high capacity, fold in the support.

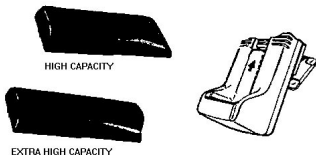

REMOVING THE RADIO

Gently pull out on the top of the radio until you feel it loosen, then remove the phone.



SPECIFICATIONS

- INPUT VOLTAGE 11- 16V.DC/1.7A
- CHARGING TEMPERATURE RANGE 25°F. to 105°F.

TROUBLESHOOTING

RADIO PROBLEM	PROBABLE CAUSES	SOLUTION
The VEHICLE HANDSFREE unit does not receive vehicle power	<ul style="list-style-type: none"> • cradle is wired to a switchable power source that is turned off • fuse is blown • polarity is reversed at the battery connection 	<ul style="list-style-type: none"> • if wired to the ignition switch, ignition may need to be turned on • check fuse and replace if necessary • be sure the red power cable wire is attached to the positive battery terminal, black to ground
Radio with low battery does not work in the cradle	radio battery is dead	Be sure the radio battery is charged. If not, let it charge in the cradle for 10 not minutes
Radio works outside the cradle, but not in it	<ul style="list-style-type: none"> • radio is not properly seated • system connector contacts dirty • external antenna cable attached but antenna is disconnected 	<ul style="list-style-type: none"> • be sure the radio is properly seated • clean system connector contacts • be sure the external antenna is connected
The other party of the radio connection cannot hear sound	The microphone jack is not inserted into the connection box	Clean the microphone plug and insert it into the connection box

This page intentionally left blank

Ericsson Inc.

Private Radio Systems

Mountain View Road

Lynchburg, Virginia 24502

1-800-528-7711 (Outside USA, 804-528-7711)

AE/LZT 123 1881 R1A

Printed in U.S.A.