

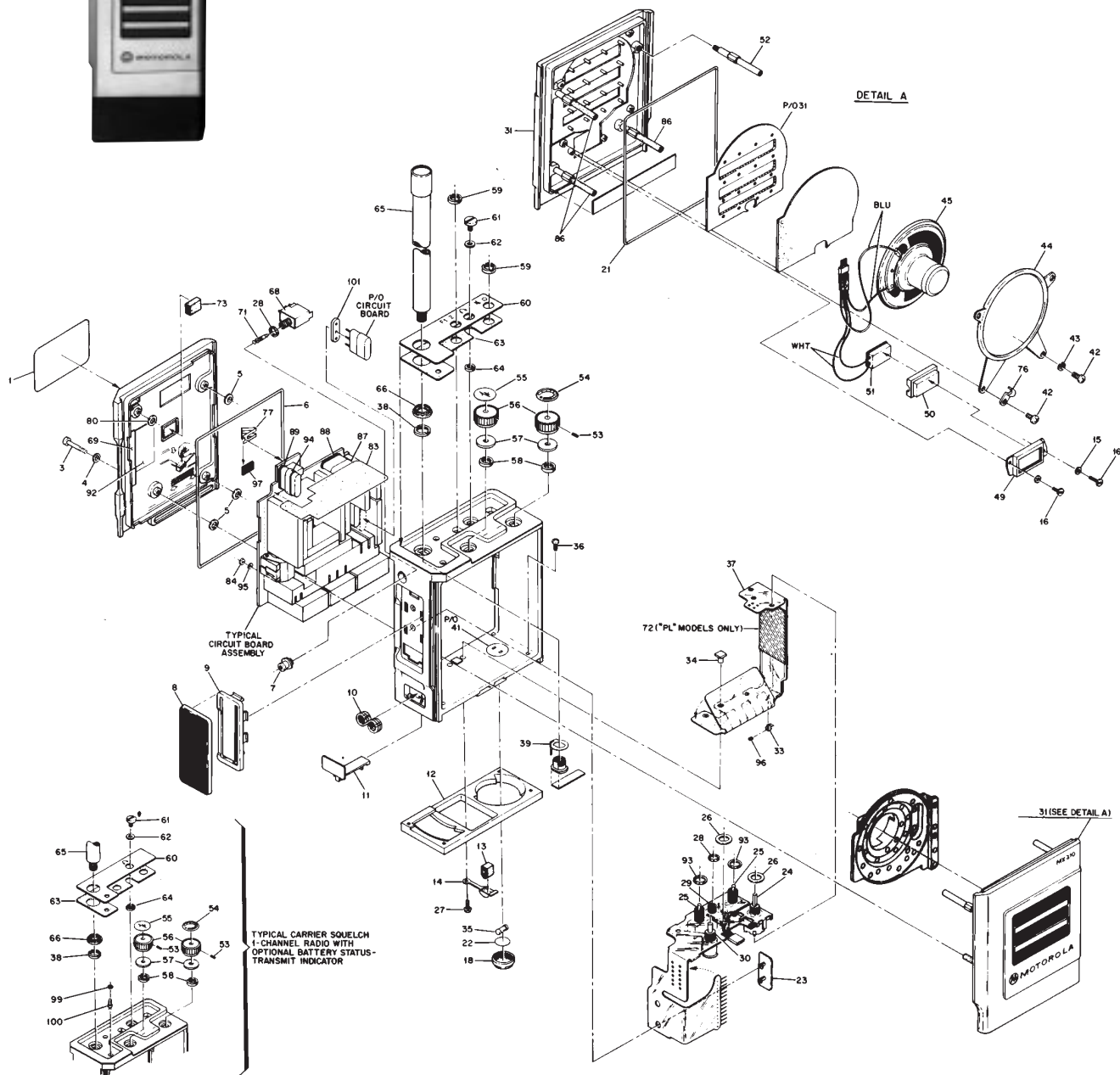

MOTOROLA

MX300 Series

Parts List



**MOTOROLA**

MX300 Series

Parts List

MX 310, H23AAB, H24AAB

| REF. NO. | PART NO. | DESCRIPTION |
|-------------|------------|--------------------------|
| 3 | 0382210E15 | Screw, captive |
| 4 | 0405465C01 | Washer, seal |
| 5 | 0405818D01 | Washer, metal |
| 6 | 3282172J11 | Gasket "O" Ring |
| 7 | 0105952G99 | Nut, retainer |
| 8 | 3205427C04 | Boot |
| 9 | 4505509C03 | Actuator |
| 10 | 4105414C01 | Spring, latch |
| 11 | 5505417C01 | Latch, battery |
| 12 | RPX4241A | Base, frame support |
| 13 | 0705830C02 | Support, battery contact |
| 14 | RPX4636A | Contact battery |
| 16 | 0300138651 | Screw |
| 18 | 3805881D01 | Cap, Fuse |
| 21 | 3282172J11 | Gasket "O" Ring |
| 22 | 1405610D01 | Insulator |
| 23 | 4205506C01 | Strain relief, snap in |
| 24 | RPX4253A | Resistor (R308) |
| 25 | 4005190D01 | Switch (S301) |
| 26 | 4205405C01 | Seal |
| 27 | 0300138651 | Screw & Lockwasher |
| 28 | 0405757E11 | Gasket |

| REF. NO. | PART NO. | DESCRIPTION |
|-------------|------------|--------------------------|
| 29 | 0905537F02 | Jack (J301) |
| 30 | 1805430C02 | Resistor (R311) |
| 31 | NLN8789A | Cover, front |
| 33 | 4205410C01 | Clip, fuse |
| 34 | 4605461C01 | Stud, battery contact |
| 35 | 6500138653 | Fuse |
| 36 | 0300138661 | Screw |
| 39 | 2905548E01 | Lug, Antenna |
| 40 | 4205383F01 | Insert, plug |
| 42 | 0305466C01 | Screw |
| 43 | 0400009743 | Washer, #4 split |
| 45 | 5005181E02 | Speaker |
| 51 | 5982575J02 | Microphone Cartridge |
| 52 | 4305467C02 | Spacer, Standoff |
| 54 | 5405511C01 | Label, Knob Vol. Control |
| 55 | 5405511C03 | Label, Knob Squelch |
| 56 | 3605510C01 | Knob |
| 57 | 0405555C02 | Washer, Thrust |
| 58 | 0281653D03 | Nut, mounting |
| 59 | 0205344C02 | Nut mounting |
| 61 | 0305857C01 | Screw, Cap |
| 62 | 0483700H04 | Washer, Insulator |

| REF. NO. | PART NO. | DESCRIPTION |
|-------------|------------|--------------------------------------|
| 63 | 1105092E02 | Adhesive Escutcheon |
| 64 | 0205256C02 | Nut, special |
| | 0483799H06 | |
| 65 | | Antenna (select appropriate antenna) |
| 71 | 0105585H01 | Plunger, Spring, Insulator |
| 80 | 0405818D01 | Washer bearing insulated |
| 83 | 1405939D01 | Insulator |
| 84 | 0205863A01 | Nut, Preselector |
| 86 | 3700137049 | Insulator |
| 87 | 0705196A01 | Boot, Xtal |
| 88 | 7505295B04 | Pad, Xtal |
| 89 | 1405736C01 | Pad, Xtal |
| 90 | ST1179 | Tool, module extraction |
| 92 | 1300868710 | Label, Patent |
| 95 | 0400115361 | Washer, #2 split |
| 97 | 1405424D04 | Insulator |
| 99 | 3205701C03 | "O" Ring |
| 100 | 4805504C01 | LED |
| 101 | 7505295B04 | Pad, Crystal base |



MOTOROLA

MX300 Series

Parts List

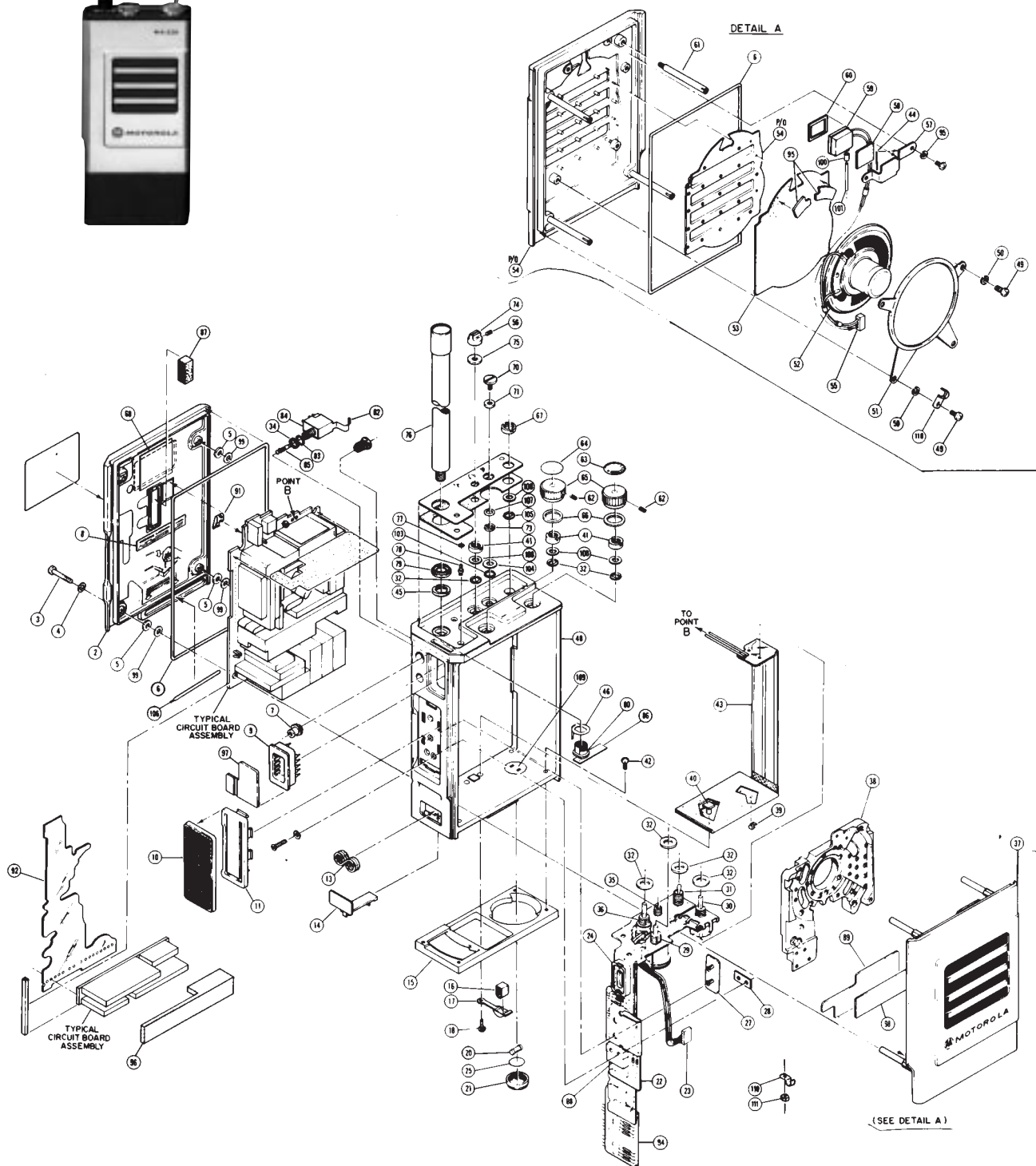

(SEE DETAIL A)



MOTOROLA

MX300 Series

Parts List

MX320, MX330, MX340, MX350, MX360, H23AAU, H24AAU, H33AAU, H43AAU, H44AAU

| REF. NO. | PART NO. | DESCRIPTION |
|----------|------------|------------------------------|
| 2 | NLN7311A | Back Cover Kit (320) |
| | NLN7312A | Back Cover Kit (330) |
| | NLN7313A | Back Cover Kit (340) |
| | NLN7314A | Back Cover Kit (350) |
| | NLN7315A | Back Cover Kit (360) |
| 3 | 0382210E15 | Screw, Captive |
| 4 | 0405465C01 | Washer Seal |
| 5 | 0405818D01 | Washer |
| 6 | 3282172J11 | Gasket "O" Ring (320) |
| | | Gasket "O" Ring (330) |
| | | Gasket "O" Ring (340) |
| | | Gasket "O" Ring (350) |
| | | Gasket "O" Ring (360) |
| 7 | 0105952G99 | Nut, Retainer Special |
| 8 | 6405535D06 | Plate, Ground Shield (320) |
| | | Plate, Ground Shield (330) |
| | | Plate, Ground Shield (340) |
| | | Plate, Ground Shield (350) |
| | | Plate, Ground Shield (360) |
| 9 | 1505673C01 | Housing, Connector |
| 10 | 3205427C04 | Boot |
| 11 | 4505509C03 | Actuator |
| 13 | 4105414C01 | Spring |
| 14 | 5505417C01 | Latch battery |
| 15 | RPX4241A | Base, Frame Support |
| 16 | 0704830C02 | Support, Battery Contact |
| 17 | RPX4636A | Contact, Battery |
| 18 | 0300138651 | Screw & Lockwasher |
| 20 | 6500139554 | Fuse Cartridge |
| 21 | 3805881D01 | Cap Fuse |
| 22 | NLN4171B | Flex Circuit Control |
| 23 | 0905552D01 | Connector J303 |
| 24 | 0905675C01 | Socket J302 |
| 25 | 1405610D01 | Insulator, Spacer |
| 26 | 4205506C01 | Strain Relief, Snap In |
| 27 | | |
| 28 | 6405683F01 | Plate, Nut |
| 29 | 0105952E63 | Switch (S501-S301) |
| 30 | RPX4253A | Resistor (R308) |
| 31 | 4005190D01 | Switch (S303) |
| 32 | 4205405C01 | Seal |
| 34 | 3205295F01 | Gasket |
| 35 | 0905537F02 | Jack |
| 36 | 1805430C02 | Resistor |
| 37 | NLN8790A | Front Cover (320) |
| | NLN7420A | Front Cover (330) |
| | NLN7421A | Front Cover (340) |
| | NLN7422A | Front Cover (350) |
| | NLN7423A | Front Cover (360) |
| | NLN8796A | Front Cover (330 High Power) |
| | NLN7424A | Front Cover (340 High Power) |
| | NLN7425A | Front Cover (350 High Power) |
| | NLN7426A | Front Cover (360 High Power) |
| 38 | 7505589E03 | Pad |
| 39 | 425410C01 | Clip Fuse |
| 40 | 4605461C01 | Stud |

| REF. NO. | PART NO. | DESCRIPTION |
|----------|------------|---|
| 41 | 0282653D03 | Nut, Mounting (1/4-32) |
| | 0282653D05 | Nut, Mounting (1/4-28) |
| 42 | 0300138661 | Screw |
| 43 | 0105953C37 | Power Flex Circuit (320) |
| | 0105953C38 | Power Flex Circuit (330) |
| | 0105953C39 | Power Flex Circuit (340) |
| | 0105953C40 | Power Flex Circuit (350) |
| | 0105953C41 | Power Flex Circuit (360) |
| 44 | 1405424D04 | Insulator (.21" x .21") |
| | 1482302E05 | Insulator (.31" x .31") |
| 45 | 0205543E01 | Nut Mounting |
| 46 | 2905548E01 | Lug, Antenna |
| 48 | RPX4624A | Frame (320) |
| | RPX4625A | Frame (330) |
| | RPX4626A | Frame (340) |
| | RPX4627A | Frame (350) |
| | RPX4628A | Frame (360) |
| 49 | 0305466C01 | Screw Slotted (180 Special Head) |
| | 0305466C02 | Screw Slotted (219 Standard Head) |
| 50 | 0400009743 | Washer, #4, Split |
| 51 | 0705423C01 | Bracket, Ring (Low & Medium Power) |
| | 0705875C01 | Bracket, Ring (High Power) |
| 52 | 5005181E02 | Speaker |
| 53 | 3505866N01 | Cover Speaker Felt |
| 54 | 0105953B83 | Cover & Grille (320) |
| | 0105957B51 | Cover & Grille (330) |
| | 0105959B38 | Cover & Grille (340) |
| | 0105959B39 | Cover & Grille (350) |
| | 0105959B40 | Cover & Grille (360) |
| 55 | 2805551D01 | Plug (High Power) |
| | 2805551D03 | Plug (Low & Medium Power) |
| 56 | 0305480E01 | Setscrew |
| 57 | 0705770M01 | Clip Mounting |
| 58 | 7582745J02 | Pad Pressure |
| 59 | 5982575J02 | Microphone (With .036" center hole) |
| | 5982575J03 | Microphone (Without .036" center hole) |
| 60 | 3205468C01 | Gasket, Microphone (Low & Medium Power) |
| | 1405445G02 | Gasket, Microphone (High Power) |
| 61 | 4305467C02 | Spacer Standoff |
| 62 | 0305480E01 | Screw |
| 63 | 5405511C01 | Label Knob, Vol. Control |
| 64 | 5405511C03 | Label, Knob (1 Freq. models) |
| | 3305484G01 | Label, Knob (2 Freq. models) |
| | | Label, Knob (4 Freq. models) |
| | | Label, Knob (6 Freq. models) |
| | | Label, Knob (8 Freq. models) |
| 65 | 3604410C01 | Knob |

| REF. NO. | PART NO. | DESCRIPTION |
|----------|------------|---------------------------------------|
| 66 | 0405555C02 | Washer, Thrust |
| 67 | 0205344C02 | Nut, Special |
| 70 | 0305857C01 | Screw Cap |
| 71 | 0482799H04 | Washer, Insulator |
| 73 | 0205256C02 | Screw |
| 74 | 3605577C01 | Knob |
| 75 | 0405342C01 | Washer, Thrust |
| 76 | NAD6283A | Antenna (150.8-162 MHz) |
| | NAD6284A | Antenna (162-174 MHz) |
| | | Antenna (403-430 MHz) |
| | | Antenna (440-470 MHz) |
| | | Antenna (470-512 MHz) |
| 77 | 3205701C03 | "O" Ring |
| 78 | 4805504C01 | (CR303) Diode |
| 79 | 1405545E01 | Insulator |
| 82 | 2605767C05 | Shield Jack |
| 83 | 0484345A06 | Washer |
| 84 | 0905505C02 | Antenna Jack (.135 ground term.) |
| | 0905537F02 | Antenna Jack (.161 ground term.) |
| 85 | 0105585H01 | Plug Spring and Insulator |
| 87 | 7505585C01 | Pad, Pressure |
| 88 | 4082159D01 | Switch Ptt |
| 91 | 3905188D03 | Spring Grounding |
| 92 | 8405812C01 | Flex Circuit Interconnect (1-2 Freq.) |
| | 8405111D01 | Flex Circuit Interconnect (4 Freq.) |
| | 8405112D01 | Flex Circuit Interconnect (6-8 Freq.) |
| 94 | NLD6881A | Switch & Flex, VHF, 4F |
| | NLD6891A | Switch & Flex, VHF, 6F |
| | NLD6901A | Switch & Flex, VHF, 8F |
| | NLE8382A | Switch & Flex, UHF, 4F (High Power) |
| | NLE8392A | Switch & Flex, UHF, 6F (High Power) |
| | NLE8402A | Switch & Flex, UHF, 8F (High Power) |
| 96 | 7505890C01 | Pad, Digital P1 Contour |
| 97 | 3205163E01 | Boot |
| 98 | 1405576E02 | Insulator (330) |
| | 1405576E03 | Insulator (340) |
| | 1405576E04 | Insulator (350) |
| | 1405576E05 | Insulator (360) |
| 99 | 0405248E01 | Washer |
| 100 | 3705144E01 | Sound pipe (High Power) |
| 101 | 4705143E01 | Tubing, Flexible (High Power) |
| 102 | 7505705D01 | Pad |
| 103 | 0405757E01 | Seal |
| 104 | 0405342C02 | Washer |
| 105 | 0405757E02 | Seal |
| 106 | ST1179 | Tool Module Pusher |
| 107 | 0483799H06 | Washer |
| 108 | 0405342C03 | Washer |
| 109 | 4205383F01 | Plug |
| 111 | 0200120487 | Nut, hex |



MOTOROLA

MX300 Series

Portable Accessories

CHARGERS

Single Unit Chargers

Single unit chargers are designed for desktop use and are capable of charging a battery on or off the radio. When the battery is fully charged, the charger automatically resets to a trickle charge rate. Rapid charge batteries must be charged in the rapid charge unit to attain the rapid charge rate. Visual indication is provided in the rapid charger when the battery is fully charged.



NLN8858A

NLN8858A Single Unit, 1 Hour, Rapid Charger, 117 Volts

NLN4038A* Single Unit, 1 Hour, Rapid Charger, 220 Volts

NLN8856A Single Unit, 14 Hour, Standard Charger, 117 Volts

NLN4036A* Single Unit, 14 Hour, Standard Charger, 220 Volts

* Unit is supplied without line cord plug.

Multiple Unit Chargers

Multiple unit chargers are designed for large users or multishift operations where spare batteries are required. Can be desk or rack mounted, and accommodates up to 6 radios or batteries. Visual indication is provided in the rapid charger when the battery is fully charged.

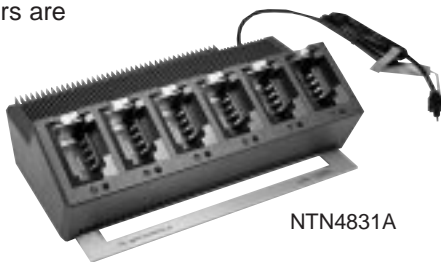

NTN4831A

NTN4831A Multiple Unit, 1 Hour, Rapid Charger, 117/220 Volts

NTN4832A Multiple Unit, 14 Hour, Standard Charger, 117/220 Volts

BATTERY MAINTENANCE SYSTEM (BMS)

Using interchangeable battery adapters (order separately), the BMS is capable of charging and discharging batteries, tracking battery voltage and capacity (mAh).

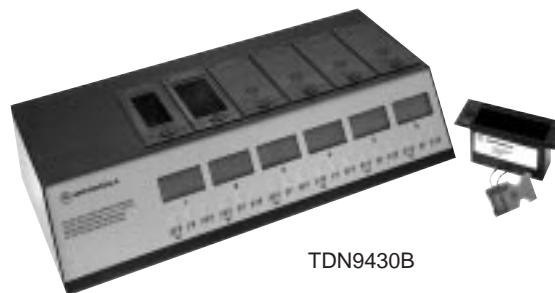

TDN9430B

TDN9430B Six Station, 110V AC, 50/60 Hz

TDN9431B Six Station, 230V AC, 50/60 Hz

TDN9720B Six Station, 110V AC, 50/60 Hz, CSA Approved

NDN4005B Three Station, 110V AC 50/60 Hz

NDN4006B Three Station, 230V AC, 50/60 Hz

NDN4007B Three Station, 110 V AC, 50/60 Hz, CSA Approved

TDN9432A Adapter, Universal Clip Lead

TDN9527A Adapter, Universal Dip Switch

TDN9445A Adapter, 7.5V, 1000/1100/1250/2800 mAh



MOTOROLA

MX300 Series

Portable Accessories

BATTERY DISCHARGE TESTER

Tester determines a battery's delivered capacity by discharging a fully charged battery. 'LED' indicates cycle status by turning "ON" when fully charged battery is placed in adapter and "OFF" when discharge is complete. Plug-in adapters allow one console to discharge most batteries. No AC power source required (console is powered by discharging battery).



RLN4201B

RLN4201B Single Unit Battery Discharge Tester, Requires Battery Adapter or Cable/Clip Lead

RLN4317A Battery Adapter MX300

RKN4037A Cable/Clip Lead, 7.5V

AUDIO ACCESSORIES

UHF and VHF Surveillance Accessories

NMN6091A VHF Surveillance Accessory

NMN6092A UHF Surveillance Accessory

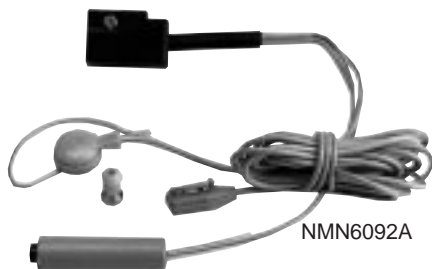

NMN6092A

AUDIO ACCESSORIES

Remote Speaker/Microphones

Remote speaker/microphone allows user to talk and listen without removing radio from belt or carrying case. Ideal in high noise level areas. Straight and coil cord remote units have back clip for attachment to upper garment. Wired earpiece available for all models.

NMN6070B Remote Speaker Microphone Straight Cord with Clip Back

NMN6071B Remote Speaker Microphone Coil Cord with Clip Back

NMN6072A UHF Public Safety Microphone with High/Low Switch and PTT, order Velcro Patch and Antenna separately.

Antennas for NMN6072A

8505355K03404-430 MHz, Heliflex

8505355K04440-470 MHz, Heliflex

8505309N11470-512 MHz, Heliflex



NMN6070B



NMN6071B



NMN6072A



MOTOROLA

MX300 Series

Portable Accessories

AUDIO ACCESSORIES

Epaulet Strap

Black leather epaulet straps secure remote speaker microphones to epaulet of shirts or jackets and attach around cord. Allows reliable communications in hostile environments with Velcro or Clip style strap.

RLN4294A Epaulet Strap, Velcro

RLN4296A Epaulet Strap, Large Clip



RLN4294A



RLN4296A

Vehicle Antenna Adapter Cable

NKN6223A 48" Long, UHF and High Band Only

Velcro Patch

NLN8410A Velcro Patch Pin Attachment, (for NMN6072A Microphone)

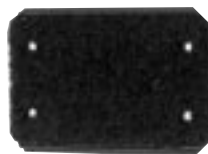

NLN8410A

Earpiece

5005178K01 Earpiece, Without Volume Control

5080332A41 Plastic Insert for Earpiece



5005178K01

AUDIO ACCESSORIES

Headset/Microphones

Maintain portable two-way communications in high ambient noise areas with noise cancelling accessories. Both weatherproof models can be worn with or without a safety type helmet.



NMN6065A

NMN6065A Noise Canceling Headset/Microphone with Cup Microphone



NMN6064A

NMN6064A Noise Canceling Headset/Microphone with Boom Microphone

NKN6207A Adapter Kit (required for noise cancelling headsets)



5084972H01 Earpiece Headset/Microphone

5084972H01

NMN6050A Safety Helmet Headset/Microphone

NLN8875A Adapter (required for NMN6050A 5084972H01)



NMN6050A



MOTOROLA

MX300 Series

Portable Accessories

AUDIO ACCESSORIES

Speaker Microphones

NMN6123B Waterproof Speaker/Microphone with Straight Cord and Swivel Clip

NMN6124B Waterproof Speaker/Microphone with Coiled Cord and Velcro Patch

NMN6125B Waterproof Speaker/Microphone with Coiled Cord and Swivel Clip



NMN6123B

Ear Mikes

Single unit microphone and speaker worn in the ear. Eliminates the need for handheld microphones or conventional headsets. Compact, rugged design allows use under hearing protectors and protective clothing. Order cable separately.

RMN4001B Ear Mike, EM200

0180359A41 Interface Cable for MX300

0180359A51 Optional PTT Ring Switch for RMN4001A only

0180356B97 Optional PTT Ring Switch for RMN4001B only



RMN4001B



0180359A51

Cost effective alternative to the EM200, the EM150 operates the same but includes hardwired interface cable. (PTT ring switch is not compatible with this unit)

RMN4007A Ear Mike, EM150



RMN4007A

CARRYING ACCESSORIES

Carrying Cases

Standard black leather carrying cases with snap-on/off perforated full covers provide protection yet permit clear audio. T-strap covers permit easy access to all controls. The over-the-shoulder adjustable sturdy black nylon carrying strap snaps onto the belt loop case and provides a convenient way to wear a radio. Swivel carrying cases attach to belt loop attachment by inverting radio. Radio swings freely on belt loop attachment, adjusting to body movements.



1505333D07

MX310 Series Standard

1505333D03 Carrying Case for Medium Capacity Battery

1505333D05 Carrying Case for Medium High Capacity Battery

1505333D07 Carrying Case for High Capacity Battery



MX310 Series Swivel

NLN4118A Carrying Case for Light Capacity Battery

NLN4120A Carrying Case for Medium High Capacity Battery

NLN4122A Carrying Case for High Capacity Battery



NLN4122A

NLN4118A



MOTOROLA

MX300 Series

Portable Accessories

CARRYING CASES

MX320 Series Standard

1505333D03 Carrying Case for Light and Medium Capacity Battery, with 2½" Belt Loop

1505333D04 Carrying Case for Medium High Capacity Battery, with 2½" Belt Loop

1505333D06 Carrying Case for High Capacity Battery and/or Non-Rechargeable Battery, with 2½" Belt Loop

1505333D08 Carrying Case for Ultra-High Capacity Battery, with 2½" Belt Loop



1505333D03

MX320 Series Swivel

NLN4118A Carrying Case for Light and Medium Capacity Battery, with 3" Belt Loop

NLN4119A Carrying Case, for Medium Capacity Battery, with 3" Belt Loop

NLN4121A Carrying Case for High Capacity Battery and/or Non-Rechargeable Battery, with 3" Belt Loop

NLN4123A Carrying Case for Ultra-High Capacity Battery, with 3" Belt Loop



NLN4118A



1505333D07

MX330 Series Standard

1505333D03 Carrying Case for Light Capacity Battery, with 2½" Belt Loop

1505333D04 Carrying Case for Medium Capacity Battery, with 2½" Belt Loop

1505333D05 Carrying Case for Med-Light Capacity Battery, with 2½" Belt Loop

1505333D07 Carrying Case for High Capacity Battery and/or Non-Rechargeable Battery, with 2½" Belt Loop

1505333D09 Carrying Case for Ultra-High Capacity Battery, with 2½" Belt Loop

CARRYING CASES

MX330 Series Swivel

NLN4118A Carrying Case for Light Capacity Battery, with 3" Belt Loop

NLN4119A Carrying Case for Medium Capacity Battery, with 3" Belt Loop

NLN4120A Carrying Case for Med-High Capacity Battery and/or Non-Rechargeable Battery, with 3" Belt Loop

NLN4122A Carrying Case for High Capacity and/or Non-Rechargeable Battery, with 3" Belt Loop

NLN4124A Carrying Case for Ultra-High Capacity Battery, with 3" Belt Loop



NLN4122A

MX340 Series Standard

1505333D04 Carrying Case for Light and Medium Capacity Battery, with 2½" Belt Loop

1505333D06 Carrying Case for Med-High Capacity and/or Non-Rechargeable Battery, with 2½" Belt Loop

1505333D08 Carrying Case for High Capacity and/or Non-Rechargeable Battery, with 2½" Belt Loop

1505333D09 Carrying Case for Ultra-High Capacity Battery, with 2½" Belt Loop



1505333D08